

2 SITE PLAN
SCALE: 1" = 20'-0"

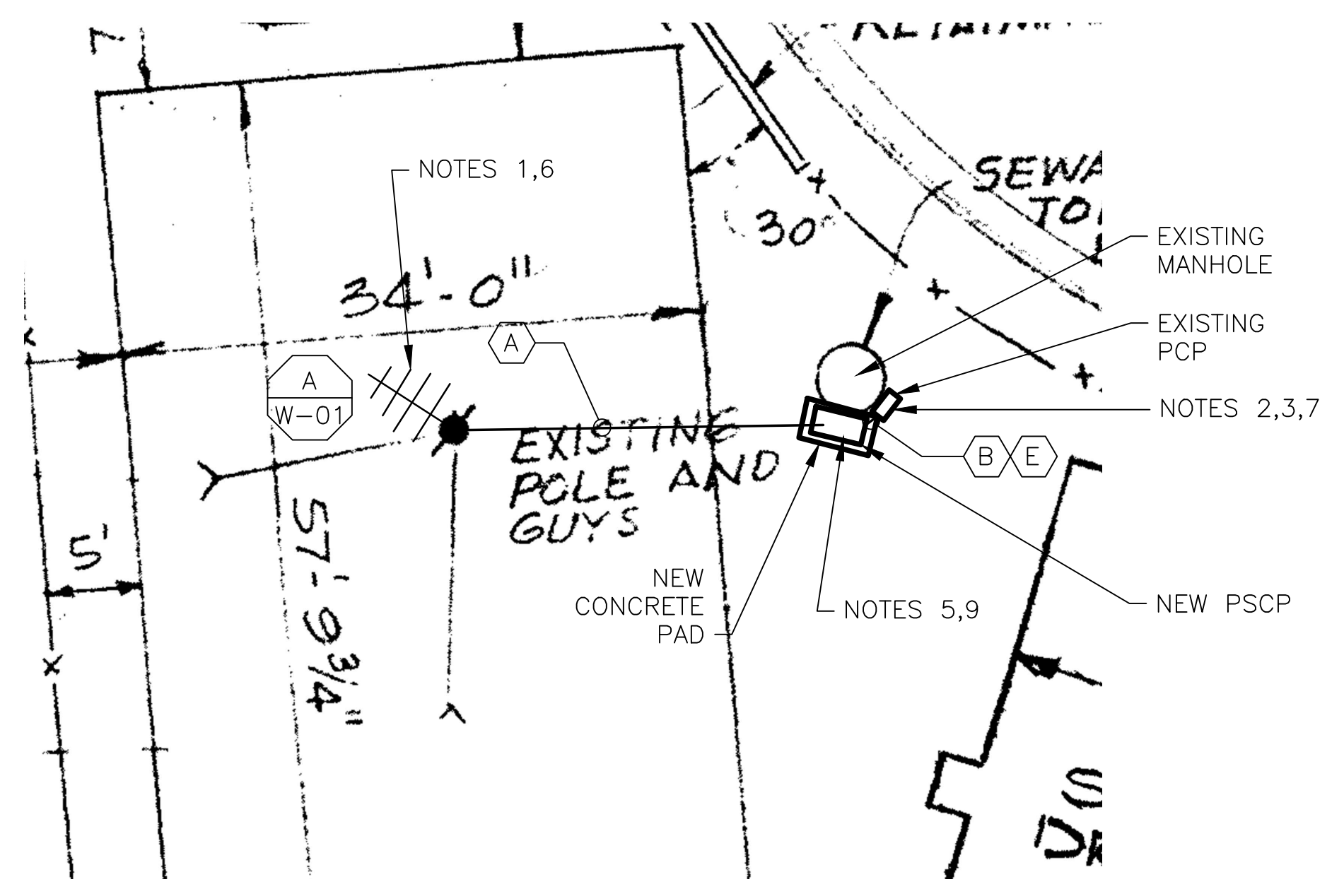

1 PANEL LOCATIONS
SCALE: 1/8" = 1'-0"



3 ANTENNA LOCATION
SCALE: NTS

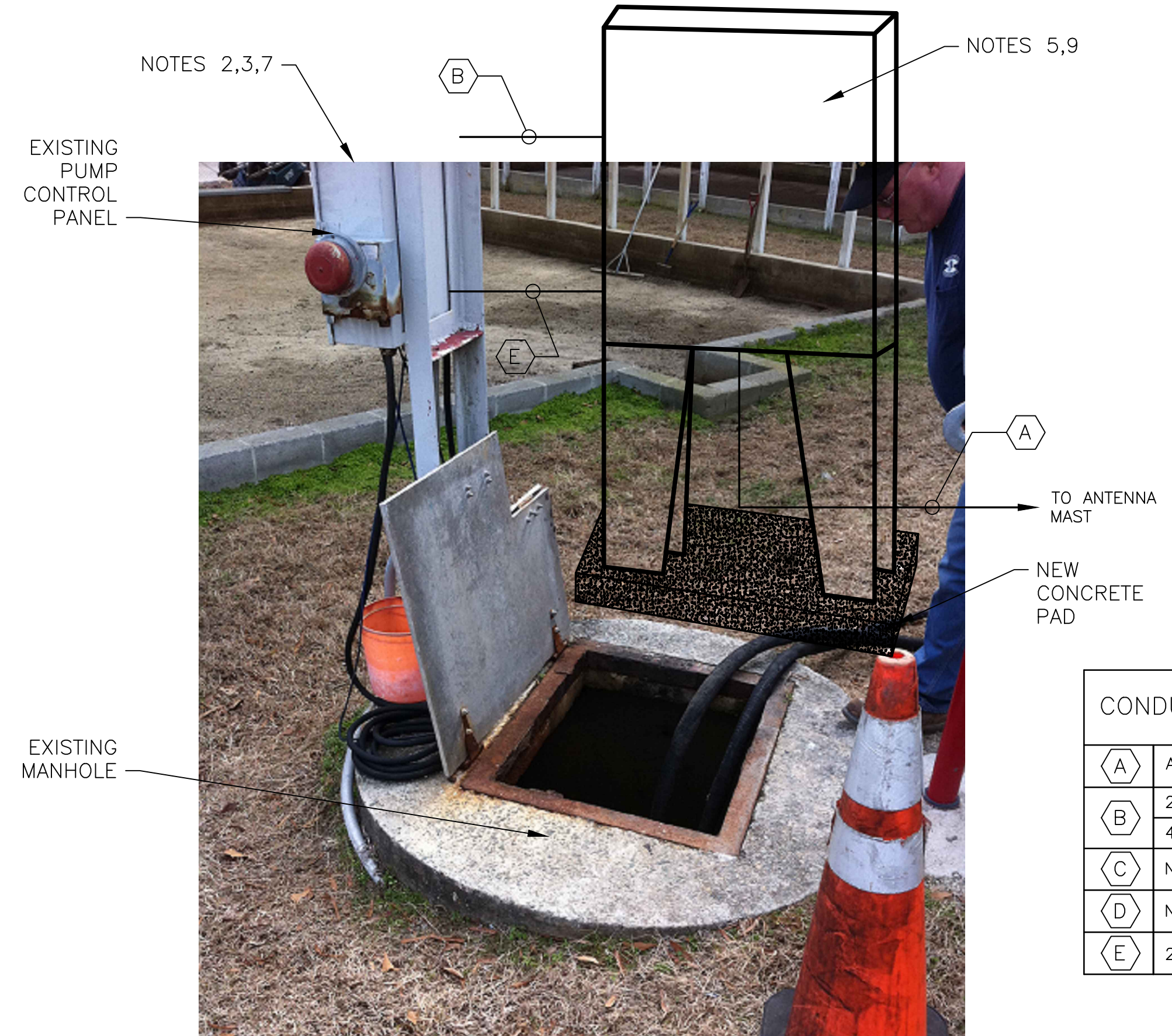

4 MANHOLE ENCLOSURE
SCALE: NTS

- NOTES:**
- EXISTING YAGI ANTENNA, MAST AND CABLE TO BE REMOVED AFTER SUCCESSFUL INSTALLATION OF THE NEW PUMP STATION CONTROL PANEL (PSCP).
 - EXISTING MOSCAD UNIT AND RADIO TO BE REMOVED FROM EXISTING PANEL.
 - EXISTING TELOG PANEL TO REMAIN. REMOVE EXISTING ANALOG AND DIGITAL INPUTS BETWEEN MOSCAD UNIT AND TELOG UNIT. REPLACE THESE SIGNALS WITH IDENTICAL SIGNALS ORIGINATING FROM THE NEW PSCP.
 - NOT USED.
 - REFER TO DRAWING G-11 FOR DETAILS OF THE CONSTRUCTION PHASING REQUIREMENTS FOR THE NEW PSCP.
 - INSTALL NEW STEEL POLE, ANTENNA CABLE AND ANTENNA. REFER TO SECTION 17375 FOR STEEL POLE REQUIREMENTS.
 - PROVIDE NEW TERMINAL BLOCKS IN EXISTING PANEL AND EXTEND EXISTING CONTROL WIRING TO THE NEW PSCP.
 - NOT USED.
 - REFER TO DRAWING G-16 FOR PANEL LAYOUT.

CONDUIT/CABLE SCHEDULE	CABLE LENGTH
A ANTENNA CABLE, REFER TO W-01 DETAIL A	200 FT
B 22 #14 IN 3/4"C	20 FT
C 4 STP IN 3/4"C	20 FT
D NOT USED	N/A
E 2 #12, 1 #12 GND IN 3/4"C	20 FT



ISSUE	DATE	DESCRIPTION
1	MAR 27 2015	CONFORMED DRAWINGS
0	DEC 2014	BID

PROJECT MANAGER:	D. FOOTE
DESIGNED BY:	B. BUTLER
DRAWN BY:	G. BUI
PROJECT NUMBER:	8582

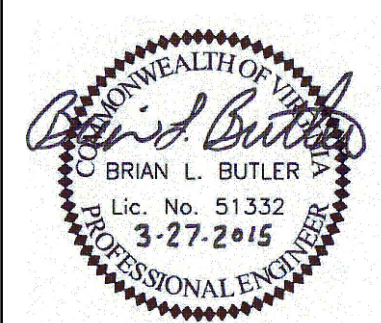

HAMPTON ROADS SANITATION DISTRICT
VIRGINIA BEACH, VIRGINIA

INTERCEPTOR SYSTEMS PUMP STATION
CONTROL AND SCADA

MATHEWS COURTHOUSE SQUARE
GRAVITY LIFT STATION
SITE PLAN

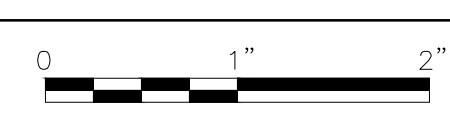

FILENAME	0616EM27.DWG
SCALE	AS NOTED

DRAWING NUMBER	EM-27
SHEET	172 OF 256