

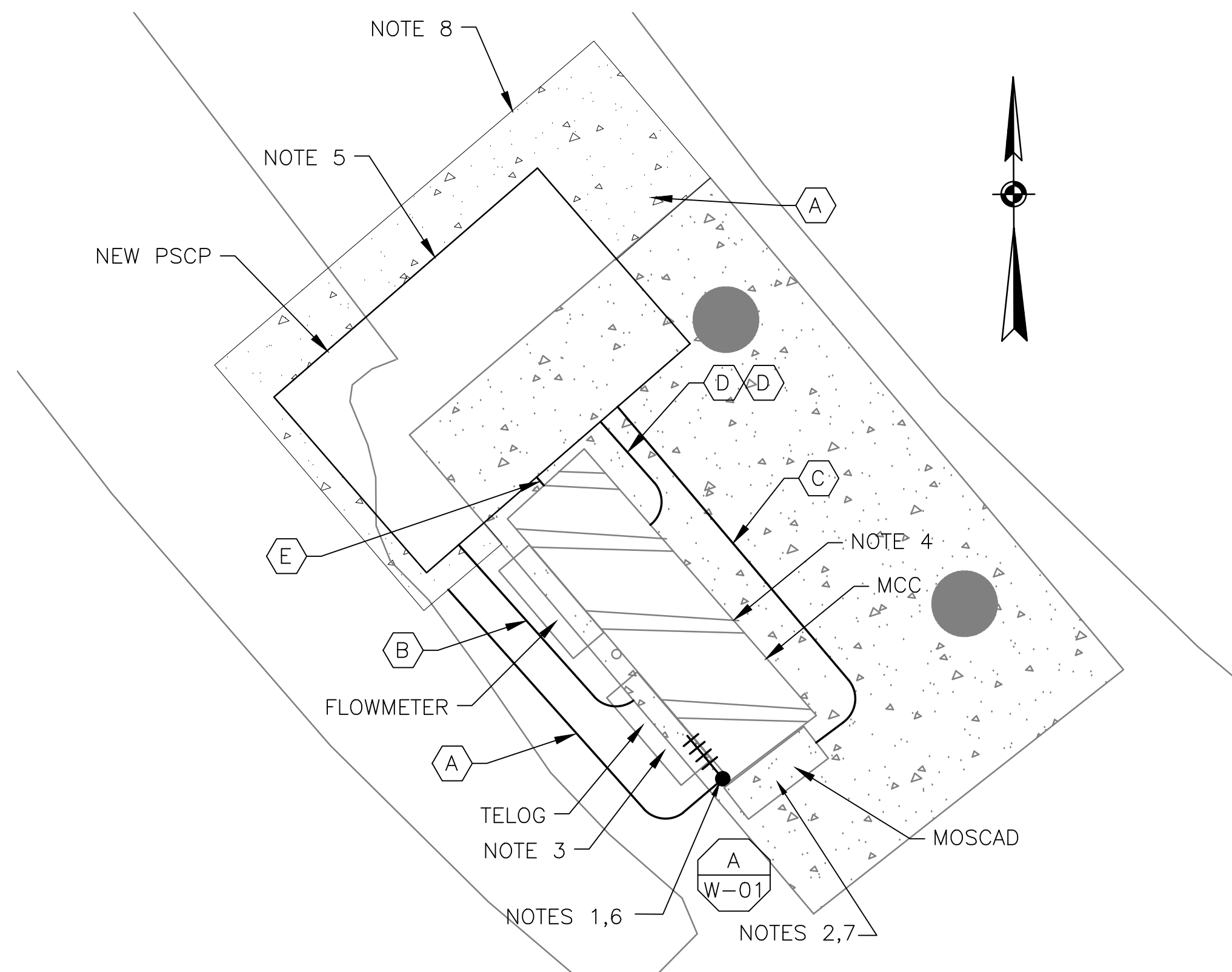

**3 SITE PLAN**  
SCALE: NOT TO SCALE



**1 EQUIPMENT PAD PLAN**  
SCALE: 1" = 1'-0"



**2 EXISTING ANTENNA LOCATION**  
SCALE: NOT TO SCALE

**NOTES:**

1. EXISTING YAGI ANTENNA AND CABLE TO BE REMOVED AFTER SUCCESSFUL INSTALLATION OF THE NEW PUMP STATION CONTROL PANEL (PSCP).
2. EXISTING MOSCAD UNIT AND RADIO TO BE REMOVED FROM EXISTING PANEL.
3. EXISTING TELOG PANEL TO REMAIN. REMOVE EXISTING ANALOG AND DIGITAL INPUTS BETWEEN MOSCAD UNIT AND TELOG UNIT. REPLACE THESE SIGNALS WITH IDENTICAL SIGNALS ORIGINATING FROM THE NEW PSCP.
4. EXISTING MOTOR STARTER PANEL TO REMAIN.
5. REFER TO DRAWING G-11 FOR DETAILS OF THE CONSTRUCTION PHASING REQUIREMENTS FOR THE NEW PSCP.
6. INSTALL NEW ANTENNA ON TOP OF EXISTING STEEL POLE. SHIFT EXISTING ANTENNA DOWN 3'. INSTALL NEW ANTENNA CABLE.
7. PROVIDE NEW TERMINAL BLOCKS IN EXISTING PANEL AND EXTEND EXISTING CONTROL WIRING TO THE NEW PSCP.
8. EXTEND CONCRETE PAD FOR INSTALLATION OF A FREE STANDING PSCP.
9. REFER TO DRAWING G-18 FOR PANEL LAYOUT.

CONDUIT/CABLE SCHEDULE	
A	ANTENNA CABLE, REFER TO W-01 DETAIL A
B	2 #12, 1 #12 GND IN 3/4" C
	6 #14 IN 3/4" C
	6 STP IN 1-1/2" C
C	50 #14 IN 1-1/2" C
	6 STP IN 3/4" C
D	20 #14 IN 3/4" C
E	2 #12, 1 #12 GND IN 3/4" C



ISSUE	DATE	DESCRIPTION
1	MAR 27 2015	CONFORMED DRAWINGS
0	DEC 2014	BID

PROJECT MANAGER:	D. FOOTE
DESIGNED BY:	B. BUTLER
DRAWN BY:	G. BUI
PROJECT NUMBER:	8582

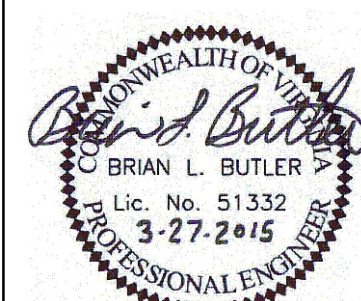

**HAMPTON ROADS SANITATION DISTRICT**  
**VIRGINIA BEACH, VIRGINIA**

**INTERCEPTOR SYSTEMS PUMP STATION**  
**CONTROL AND SCADA**

**INGLESIDE ROAD**  
**GRAVITY LIFT STATION**  
**NO 148**  
**SITE PLAN**



FILENAME	05148ES70.DWG
SCALE	AS NOTED

DRAWING NUMBER	ES-70
SHEET	153 OF 256